

HAL-TEX 5 SQ. x 40" 30 MINUTE

Breather Type Building Paper

Description

A heavy kraft paper which has been saturated with asphalt. This product sheds water and restricts moisture from penetrating. However, it will allow the passage of water vapor, thus permitting wood to "breathe". This product is guaranteed to exceed 30 minutes of water resistance when tested per U.S. standard UUB - 790a.

Uses

Used on outside walls of wood frame buildings, under the external finish, as a secondary protective barrier against entry of wind and moisture. Can be applied beneath wood siding, stucco, brick, aluminum, vinyl, or any other type of siding. Also can be applied under roofing shingles to prevent wind-blown moisture from reaching wood roof decking.

Specifications

Conforms to:	CAN 2-51.32 and U.S. UUB-790a
Rolls width:	1016 mm (40")
Contents:	46.45 sq.m. (500 sq.ft.)
SEE CCMC Evaluation	No. 11479

Packaging

Rolls per pallet:	75
Pallet size:	36" x 48"

Method of Application

- Follow all requirements of the governing building code for the jurisdiction of use.

Figure 1: HAL-TEX 2-Ply Installation Guide

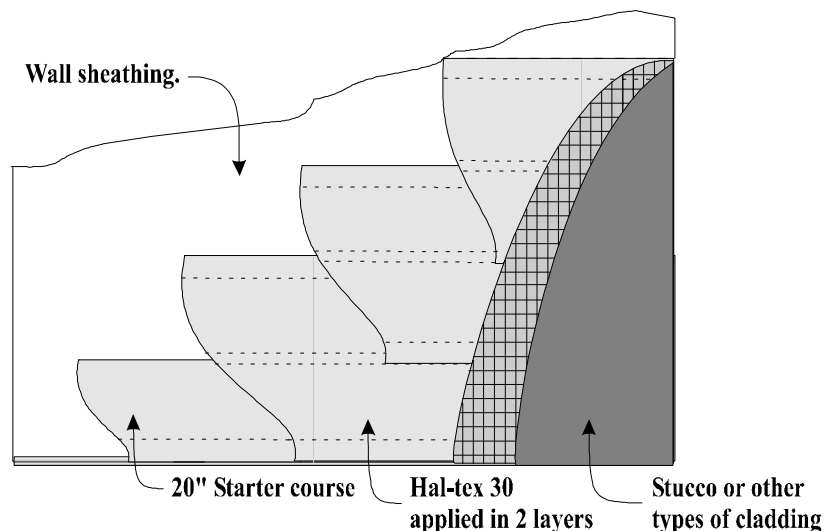

Continued on next page

HAL-TEX 5 SQ. x 40" 30 MINUTE Cont'd

- **Exterior Wood Frame Walls:** (*NOTICE: REVISED APPLICATION METHOD*)

As per above Figure 1. Two layers are recommended to be installed under all types of claddings.

Step 1. Begin by installing a 508 mm (20") half roll as a starter course horizontally 50 mm (2") below the lowest point of the wood framing.

Step 2. Install a full width 1016 mm (40") sheet completely over the starter course.

Step 3. Continue half-lapping up the wall in shingle fashion overlapping the top sheet down to the lower of the 2 lines in the center of the previously installed course. This line is 534 mm (21") down from the top of the sheet and allows a safety margin that ensures a 2-ply application. All tie-ins to window frames or other wall openings shall be sealed with a waterproof construction tape. Vertical laps shall be made where required and have a minimum 300 mm (12") overlap.

- **Lap Sealing and Damage control:**

For optimum protection against moisture entry, all vertical laps shall be sealed with a waterproof construction tape. All fasteners shall penetrate the sheet in a neat fashion so as to minimize entry points for moisture. Wherever the sheathing is torn or damaged either by fasteners or in other ways, the holes or tears shall be sealed with a waterproof construction tape.

- **Drainage Cavity:**

For certain conditions a 10 mm drainage cavity is recommended behind cladding to prevent moisture entrapment which can lead to wood rot and mould growth. Such conditions occur where the wall has a high moisture loading potential in regions where there has been a history of moisture related wall failures such as coastal regions. Insufficient roof overhang and wind action can also contribute to this condition. Check with local professionals who are experts in building envelope design. As a drainage cavity is required for brick, we recommend that stone-facing should have a minimum 10mm drainage cavity behind it.

The information presented herein, while not guaranteed, is to the best of our knowledge true and accurate. Except when agreed to in writing for specific conditions of use, no warranty or guarantee expressed or implied is made regarding the performance of any product, since the manner of use and handling are beyond our control. The user of such information assumes all risk connected with the use thereof. Nothing contained herein is to be construed as permission or as a recommendation to infringe any patent.